



Louvres Sunscreens Natural Ventilators

Integrated Smoke/Vent Control Panel Model ISCP-001



Integrated Smoke/Vent Control Panel

Description

The Naco Integrated Smoke/Vent Control Panel is particularly designed for use in small buildings e.g. staircases. The smoke vent main control and the vent button are integrated in this control panel. It offers high equipment standard and operational comfort. An integrated service timer for monitoring of the maintenance rate, numerous connectible functions for alarm and fault. Adjustable functions like time limits for ventilation and stroke-arresting device are standard.

Product Information

- Compact smoke and heat ventilation control.
- Integrated smoke vent and ventilation buttons.
- Rugged design aluminium housing.
- 1 line, 1 group.
- Up to 3A actuating current.
- Comfort functions for daily ventilation.

Specification

Material

Solid fire-proof aluminium housing.

Features

- For natural smoke removal.
- Approval according to EN 12109-9 and EN 12101-10.
- Compact style, for 3A actuating current.
- Stabilized output voltage.
- Integrated smoke vent main control.
- Integrated vent button (behind break glass), can be switched off.
- Connection of maximum 8 smoke vent buttons and 14 fire detectors.
- Only Naco approved detectors permissible.
- Switchable smoke vent safety functions: fault = alarm, smoke vent resetting and smoke detector remote reset.
- 2 free programmable, potential free contacts.
- Possibility of connecting rain detectors or wind/rain detectors without supplementary module.
- Lockable aluminium housing for surface mounting.
- Connection possibility for visual alarm devices.
- 72 hours emergency supply in case of power failure.
- Accumulator deep discharge battery protection and status check.
- By special electronics only one 12V battery (type 8) necessary
- Smoke vent break glass and vent buttons, window drives, automatic fire detectors including wind, rain and room temperature controls available as accessories in Naco range.

Technical Data

Power supply	230V AC / 50Hz, 90VA
Output	24V DC max. 3A,
Res. ripple	<10%
Class of rating	
Monitoring	Continuous duty
Alarm / ventilation	Short-time duty
Protective system	IP 30
Temperature range	- 5°C to +40°C
Housing	Aluminium
Colour	RAL 2011, orange
Dimensions W x H x D	156 x 235 x 82mm
Weight	1.40 kg

Components



Cable and Conduit Adapter
Max. 65 x 40mm



Rain Detector, Weather
Station



Smoke/Fire Detector



Smoke Vent Break Glass

Application Example

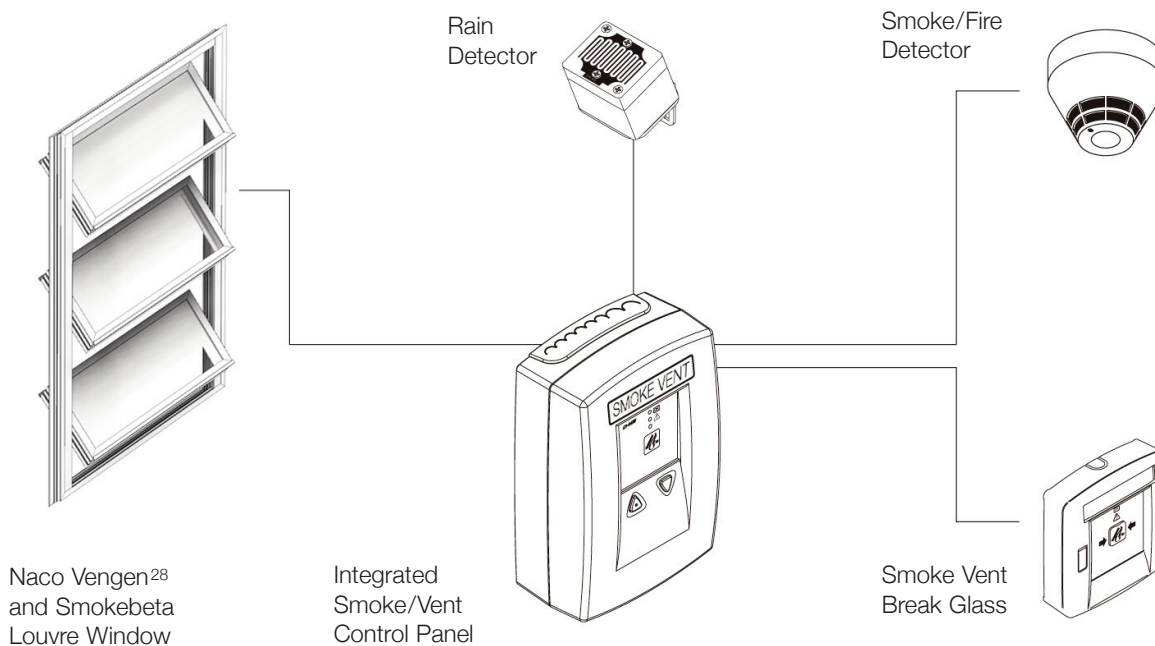

For larger systems we can offer a full design, manufacture and installation package. Please contact Naco for full details.

Important Note: All orders must be addressed to Naco, Ruskin Air Management Limited.

naco
Louvres Sunscreens Natural Ventilators

Ruskin Air Management Limited

Stourbridge Road, Bridgnorth, Shropshire,
WV15 5BB England.

Tel: 01746 761921 Fax: 01746 766450

Email: sales@naco.co.uk

Website: www.naco.co.uk

Ruskin Air Management Limited is a ISO 9001 and 14001 registered company

The statements made in this brochure or by our representatives in consequence of any enquiries arising out of this document are given for information purposes only. They are not intended to have any legal effect and the company is not to be regarded as bound thereby. The company will only accept obligations which are expressly negotiated for and agreed and incorporated into a written agreement made with its customers.

Due to a policy of continuous product development the specification and details contained herein are subject to alteration without prior notice.